

BEFORE THE HON'BLE NATIONAL GREEN TRIBUNAL
PRINCIPAL BENCH, NEW DELHI

Original Application No. 665 of 2023

Nirmal Singh Chahal

..... Applicant

Versus

State of Punjab & Ors.

..... Respondents

INDEX

Sr. No.	Particulars	Page No.
1.	Status / Action Taken Report by way of affidavit of Ravideep Singla, Environmental Engineer, Regional Office, Faridkot in compliance to order dated 24.02.2026.	
2	Annexure R 3/A A copy of letter no.276 dated 17.03.2026 alongwith report of the committee of officers.	

Date: 6th April, 2026

Place: Faridkot

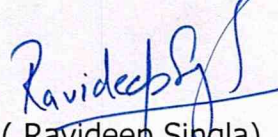
(Ravideep Singla)
Environmental Engineer,
Punjab Pollution Control Board,
Regional Office, Faridkot

**BEFORE THE HON'BLE NATIONAL GREEN TRIBUNAL
PRINCIPAL BENCH, NEW DELHI**

Original Application No. 665 of 2023

Nirmal Singh Chahal

..... Applicant

Versus

State of Punjab & Ors.

..... Respondents

Status / Action Taken Report by way of affidavit of Er. Ravideep Singla, Environmental Engineer, Regional Office, Faridkot in compliance to order dated 24.02.2026.

I, the above-named deponent, do hereby, solemnly affirm and state as under:

Respectfully Showeth

- 1) That the deponent namely Er. Ravideep Singla is working as Environmental Engineer in Punjab Pollution Control Board and is posted in the Regional Office of the Board at Faridkot. The deponent is well conversant with the facts of the case and is competent and authorized to swear and file the Status / Action Taken Report by way of affidavit in compliance to order dated 24.02.2026.
- 2) That the above-mentioned case relating to the complaint about non-operation of STP and sale of land designated for green belt / disposal of wastewater by the project proponent M/s Farid Colonizers at Faridkot is pending before this Hon'ble Tribunal.

06 APR 2026

Ravideep Singla
Environmental Engineer
Punjab Pollution Control Board
Regional Office, Faridkot



- 3) That considering the submission made by the applicant that part of green belt has been encroached upon by the owner of Shahi Haveli, this Hon'ble Tribunal was pleased to pass an order dated 24.02.2026 thereby directing the Regional Officer, Punjab Pollution Control Board to visit the site of the green belt and submit his report regarding encroachment on green belt. In this regard, para no. 17, 18 and 19 of the order dated 24.02.2026 is reproduced below for kind perusal and reference.

"17. In the course of hearing, the Applicant has submitted that the part of green belt has been encroached upon by the owner of Shahi Haveli.

18. The Regional Officer, PPCB is directed to visit the site of the green belt and to submit his report regarding encroachment on green belt. In the eventuality of any encroachment being found, the Regional Officer, PPCB shall send copy of the report to the District Magistrate cum Deputy Commissioner, Bathinda who shall initiate appropriate proceedings for demolition of unauthorized constructions/removal of encroachment immediately on receipt thereof and file his action taken report at least before one day before the next date of hearing fixed.

19. The District Magistrate cum Deputy Commissioner, Bathinda and Superintendent of Police, Bathinda are directed to provide requisite assistance to the Applicant."

- 4) That in pursuance to order dated 24.02.2026 of the Hon'ble National Green Tribunal, the Deputy Commissioner, Faridkot vide order no. 144 CEA dated 03.03.2026 has constituted a committee of the following officers to assist the Regional Officer, Punjab Pollution Control Board, Faridkot with direction submit report regarding the encroachment of green belt. A copy of the said order was circulated to all the concerned officers of Faridkot.

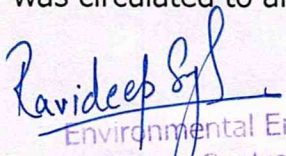
Environmental Engineer
Punjab Pollution Control Board
Regional Office, Faridkot

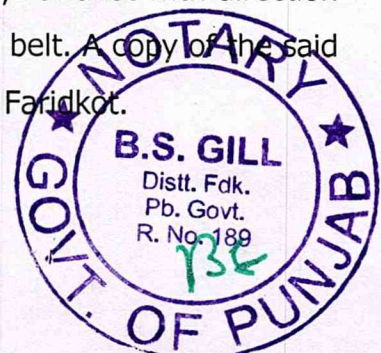

5) That the committee of officers comprising the Environmental Engineer, Punjab Pollution Control Board, Faridkot, Deputy Superintendent of Police, Faridkot, District Town Planner, Faridkot and Tehsildar Faridkot had visited the site of the project on 05.03.2026 (Farid Enclave 1 and II) and submitted its report vide letter no. 276 dated 17.03.2026 to the office of Deputy Commissioner, Faridkot with the following recommendations.

1. Encroachment over an area of 876.35 sq. feet of the park (in front of SCO's numbered 19 to 24) by Hotel Shahi Haveli (M/s Farid Enclave Phase II), the measurements of which are given below:

- i) Entrance to Hotel Shahi Haveli- 8ft x 40 ft: The entrance path may be closed along with the removal of hoarding structure of Hotel Shahi Haveli to restore the integrity of the park.
- ii) Toilets for Men and Women – 28.5 ft x 11.10 ft: Are used as a public utility.
- iii) Passage provided for toilets – 6ft x 40 ft: Is used to access the public toilets.

2. A committee comprising of the officers/officials of BDA with members of residents of Colony (Farid Enclave I & II) may be constituted to ensure that the green area of the residential colony (Farid Enclave I & II) is not encroached upon by anyone in future.

A copy of letter no.276 dated 17.03.2026 alongwith report of the committee of officers is enclosed herewith as **Annexure-A**.

6) That the office of Deputy Commissioner, Faridkot is taking appropriate action in accordance with the recommendations of the committee above-mentioned.

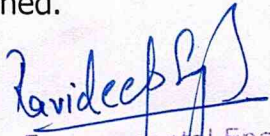

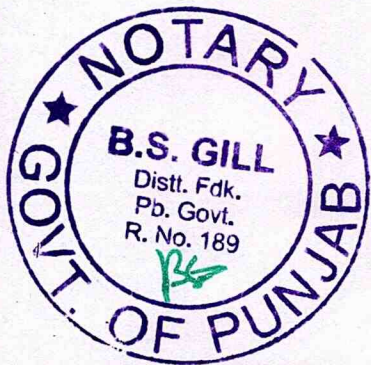
 Environmental Engineer
 Punjab Pollution Control Board
 Regional Office, Faridkot



- 7) That the deponent may kindly be allowed to place on record the Status / Action Taken Report in compliance to order dated 24.02.2026 of this Hon'ble Tribunal.

Date: 6th April, 2026

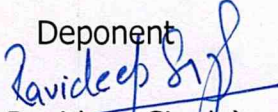
Place: Faridkot

Deponent

 (Ravideep Singla)
 Environmental Engineer,
 Punjab Pollution Control Board,
 Regional Office, Faridkot

Verification:

I, the deponent above named, do hereby verify and state that the contents of the above affidavit are true and correct to my knowledge as derived from the official record. No part of the above affidavit is false and nothing material has been kept concealed there from.

Date: 6th April, 2026

Place: Faridkot

Deponent

 (Ravideep Singla)
 Environmental Engineer,
 Punjab Pollution Control Board,
 Regional Office, Faridkot

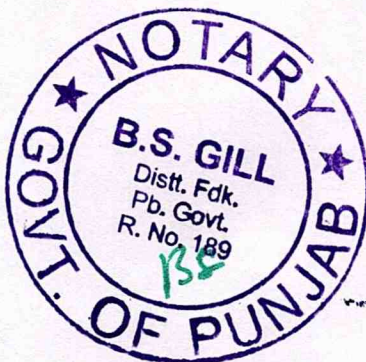

The Documents entered in my Register
 in Notarial Sr. No. 684 on the
 date of Attestation

 Balhar Singh Gill
 Notary Public Faridkot
 No. 189, Pb. Govt

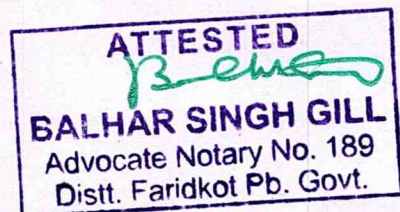

06 APR 2026



ਪੰਜਾਬ ਪ੍ਰਦੂਸ਼ਣ ਰੋਕਥਾਮ ਬੋਰਡ



PUNJAB POLLUTION CONTROL BOARD

ਨੰ: 276

ਮਿਤੀ 17/03/2026

To,

Deputy Commissioner,
Faridkot.

Subject: Visit to M/s Farid Enclave in pursuant to Hon'ble National Green Tribunal orders dated 24.02.2026 in OA No. 665 of 2023 titled as Nirmal Singh Versus State of Punjab & Ors.

Reference: Hon'ble National Green Tribunal orders dated 24.02.2026 in OA No. 665 of 2023 titled as Nirmal Singh Versus State of Punjab & Ors. and Deputy Commissioner, Faridkot office letter no. 144/CEA dated 03.03.2026.

In reference to the subject cited matter, it is submitted that the Hon'ble National Green Tribunal orders dated 24.02.2026 in OA No. 665 of 2023 titled as Nirmal Singh Versus State of Punjab & Ors. has directed as under:

- "17. In the course of hearing, the Applicant has submitted that the part of green belt has been encroached upon by the owner of Shahi Haveli.
18. The Regional Officer, PPCB is directed to visit the site of the green belt and to submit his report regarding encroachment on green belt. In the eventuality of any encroachment being found, the Regional Officer, PPCB shall send copy of the report to the District Magistrate cum Deputy Commissioner, Bathinda who shall initiate appropriate proceedings for demolition of unauthorized constructions/removal of encroachment immediately on receipt thereof and file his action taken report at least before one day before the next date of hearing fixed.
19. The District Magistrate cum Deputy Commissioner, Bathinda and Superintendent of Police, Bathinda are directed to provide requisite assistance to the Applicant."

Further, vide above referred letter Deputy Commissioner, Faridkot has constituted a committee of the following members to visit the site of the Farid Enclave located on Kotkapura Road, Faridkot and submit report regarding encroachment of green belt:

- | | |
|---|------------|
| 1. Environmental Engineer, Punjab Pollution Control Board, Faridkot | - Chairman |
| 2. District Town Planner, Faridkot | - Member |
| 3. DSP, Faridkot | - Member |
| 4. Tehsildar Faridkot | - Member |

Accordingly, site of the project was visited by the representatives of member departments on 05.03.2026 in reference to the Hon'ble Tribunal orders dated 24.02.2026 and detailed report is attached along with for your kind perusal and further necessary action in the matter.

Ravideep Singh
Environmental Engineer

Ravideep Singh
Environmental Engineer
Punjab Pollution Control Board
Regional Office, Faridkot

ਖੇਤਰੀ ਦਫ਼ਤਰ, ਫਿਰੋਜ਼ਪੁਰ ਰੋਡ, ਨੇੜੇ ਚਾਣ ਮੰਡੀ, ਫ਼ਰੀਦਕੋਟ

Regional Office, Ferozepur Road, Near Grain Market, Faridkot

Email: ppobfdk@yahoo.com

Subject: Visit to M/s Farid Enclave in pursuant to Hon'ble National Green Tribunal orders dated 24.02.2026 in OA No. 665 of 2023 titled as Nirmal Singh Versus State of Punjab & Ors.

Reference: Hon'ble National Green Tribunal orders dated 24.02.2026 in OA No. 665 of 2023 titled as Nirmal Singh Versus State of Punjab & Ors. and Deputy Commissioner, Faridkot office letter no. 144/CEA dated 03.03.2026.

In reference to the subject cited matter, it is submitted that the Hon'ble National Green Tribunal orders dated 24.02.2026 in OA No. 665 of 2023 titled as Nirmal Singh Versus State of Punjab & Ors. (copy enclosed as annexure- A) has directed as under:

"17. In the course of hearing, the Applicant has submitted that the part of green belt has been encroached upon by the owner of Shahi Haveli.

18. The Regional Officer, PPCB is directed to visit the site of the green belt and to submit his report regarding encroachment on green belt. In the eventuality of any encroachment being found, the Regional Officer, PPCB shall send copy of the report to the District Magistrate cum Deputy Commissioner, Bathinda who shall initiate appropriate proceedings for demolition of unauthorized constructions/removal of encroachment immediately on receipt thereof and file his action taken report at least before one day before the next date of hearing fixed.

19. The District Magistrate cum Deputy Commissioner, Bathinda and Superintendent of Police, Bathinda are directed to provide requisite assistance to the Applicant."

Further, Deputy Commissioner, Faridkot vide above referred letter has constituted a committee of the following members to visit the site of the Farid Enclave located on Kotkapura Road, Faridkot and submit report regarding encroachment of green belt (copy enclosed as annexure- B):

- | | |
|---|------------|
| 1. Environmental Engineer, Punjab Pollution Control Board, Faridkot | - Chairman |
| 2. District Town Planner, Faridkot | - Member |
| 3. DSP, Faridkot | - Member |
| 4. Tehsildar Faridkot | - Member |

Accordingly, committee constituted by the Deputy Commissioner, Faridkot visited the site of the project on 05.03.2026 in reference to the Hon'ble Tribunal orders dated 24.02.2026.

Details of green belt/ parks as per the approved layout plan dated 25.07.2010 for Farid Enclave Phase -I and approved layout plan dated 15.10.2005 for Farid Enclave Phase - II and revised approved layout plan dated 25.10.2021 (jointly for both colonies) (copy enclosed as annexure- C) provided by the office of the Bathinda Development Authority, Bathinda is as under:

Ravideep Singh
EE, PPCB

Ravideep Singh
Environmental Engineer
Punjab Pollution Control Board
Regional Office, Faridkot

Farid Enclave (Phase-1), Kotkapura Road, Faridkot

S.no.	Location of Park & Green Area	As per the approved layout	
		Dimensions	Area
1	Adjacent to Plot 50 and Opp to Plot 43-45	80' x 75'	666.67 sq.yds.
2	Adjacent to Nursery School/Club site Phase-1 and Opp to Plot 4-5	64' x 75'	633.33 sq.yds
		+ 15' x 60'	
3	Opposite to SCO 4-10	50' x 140'	777.77 sq.yds.
4	Opposite to SCO 1-3	24'9" x 50' Triangular Site	68.75 sq.yds.
Total Area			2146.52 sq.yds.

Farid Enclave (Phase-2), Kotkapura Road, Faridkot

S.no.	Location of Park & Green Area	As per the approved layout	
		Dimensions	Area
1	Adjacent to Plot 177 and Opp to Plot 170-172	80' x 75'	666.67 sq.yds.
2	Adjacent to School/Club site Phase-2 and Opp to Plot 111-112	73' x 75'	708.33 sq.yds
		+ 15' x 60'	
3	Opposite to SCO 11-18	40' x 160'	711.11 sq.yds.
4	Between Plot 106 & 115	54' x 75'	450 sq. yds.
5	Opposite to SCO 19-24	Irregular Shaped Park	740.78 sq.yds.
Total Area			3276.89 sq.yds.

The status of the parks/ green belts of projects at site is as under:

Farid Enclave (Phase-1), Kotkapura Road, Faridkot**1. Park adjacent to Plot 50 and opposite to plot 43-45:**

The park has been developed in common along with the park adjacent to Plot 177 and opposite to plot 170-172, Farid Enclave (Phase-II) without any boundary wall in between.

At site, the park has swings, green grass landscaping with trees planted along the boundary on three sides. A common seating area bearing dimensions 21ft x 19ft with shed has been constructed in North-West Corner. The residents informed that the structure has been raised for common use to protect the visitors from weather conditions and which also serves as a resting area for the visitors.

Ravideep Singh
EE PPCB

Ravideep Singh
Environmental Engineer
Punjab Pollution Control Board
(2) Regional Office, Faridkot



Plate-1- Photograph showing park of Farid Enclave Phase – I and Phase – II developed in common.



Plate-2- Photograph showing common structure and swings in park of Farid Enclave Phase-I

Plate - 1 & Plate- 2 shows the photographs of the park

Physical Measurements of the park is tabulated below:

S. No	Location of Park & Green Area	Dimensions as per approved map	Site verification	Remarks
1	Park adjacent to Plot 50 and opposite to plot 43-45 of Farid Enclave (Phase I)	80 ft x 75 ft	Park has been developed in single land strip with other park of Farid Enclave Phase-II of same size.	The physical measurements of the park are in consonance with the approved layout plan.

2. Park Adjacent to School/ Club site and Opp to Plot 4-5

The park has been developed in common along with the park Adjacent to School/ Club site and Opp to Plot 111-112, Farid Enclave (Phase-II) without any boundary wall in between.

Ravideep Singh
EE, PPCB

Ravideep Singh
Environmental Engineer
Punjab Pollution Control Board
Regional Office, Faridkot
③

The park is of dimensions 64 ft x 75 ft with a rectangular extension land strip bearing dimensions 60ft x 15 ft in front of internal SCO no.1 to 6. Electricity high tension pole foundation and Trees alongwith wild grass growth were observed in extension land strip of dimension 60ft x 15ft with separate boundary. Vegetable cultivation is being carried out with few trees in other portion of park having dimension as 64 ft x 75 ft. This park stretch is in common with other park in Farid Enclave Phase-II without any boundary in between and having boundary on 2 sides and at the backside wall club.

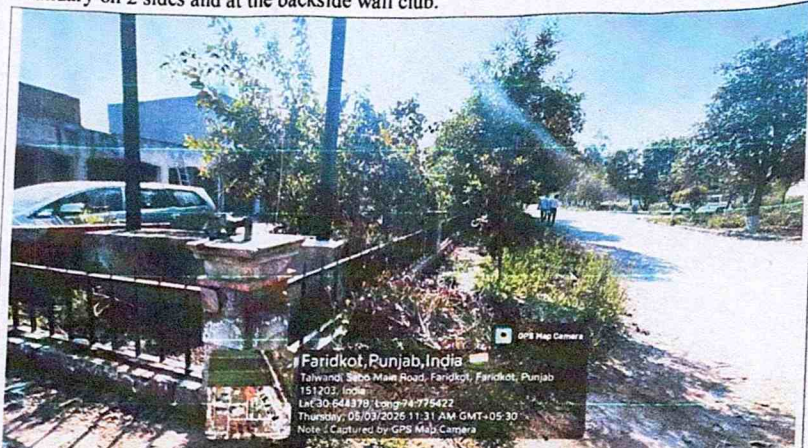

Plate 3- Land strip of park bearing dimensions 60ft x 15ft Opp to Plot 4-5 Farid Enclave (Phase I)



Plate 4: Park portion bearing dimensions 64 ft x 75 ft developed in common with other park in Farid Enclave Phase- II)

Ravideep Singh
EE PPCB

Ravideep Singh
Environmental Engineer
Punjab Pollution Control Board
Regional Office, Faridkot
(4)

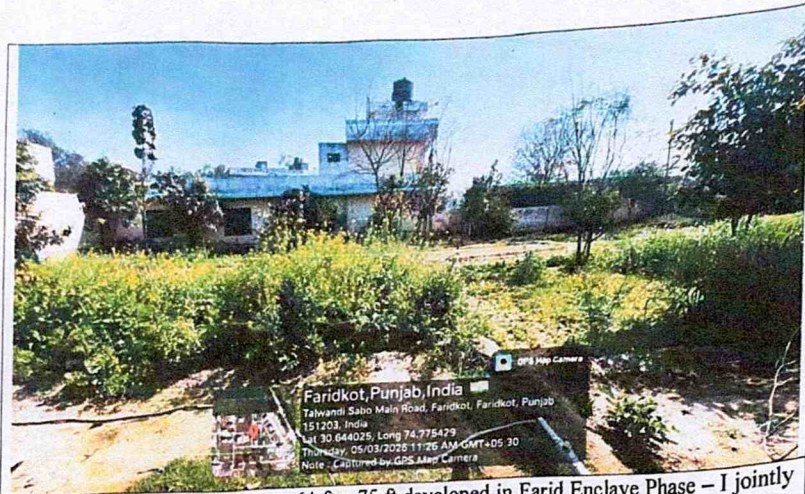

Plate 5: Park bearing dimensions 64 ft x 75 ft developed in Farid Enclave Phase – I jointly with park bearing dimensions 73 ft. x 75 ft. developed in Farid Enclave Phase- II) showing vegetable cultivation

Plate – 3, 4 and 5 shows the photographs of the park

Physical Measurement of the park is tabulated below:

S. No.	Location of Park & Green Area	Dimensions as per approved map	Site verification	Remarks
1	Park Adjacent to School/Club site Phase-I and Opp to Plot 4-5 of Farid Enclave (Phase I)	Land strip bearing dimensions 60ft x 15ft Opp to Plot 4-5 (Phase I) + Land strip bearing dimensions 64 ft x 75 ft	land strips bearing dimensions 15ft x 60ft Opp to Plot 4-5 (Phase I) with trees and wild growth and land strip bearing dimensions 64 ft x 75 ft with trees and vegetables cultivation	The physical measurements of the park are in consonance with the approved layout plan.

3. Park Opposite to SCO 4-10

The park site is located between Faridkot-Kotkapura Road and SCO's (4-10) of the Farid Enclave (Phase-I) on the left side of the approach road to the Farid Enclave Phase-I. At site, the park area has been developed in 2 portions having a boundary in between. The portion having size 40 ft x 140 ft seems to be existing area strip having boundary on 2 sides without any boundary towards Faridkot- Kotkapura Road and no boundary with park adjacent in Farid Enclave Phase-II (Opposite to SCO 11-18) of same width 40 feet. The strip of 10ft x 140 ft seems to be recently developed under green area after removing the pucca pavement as fresh row of plants have provided and excavated material of pavement was lying along the site.

The 40ft x 140 ft strip has a boundary wall on 2 sides. Green landscaping has been done along with tree plantation along the open boundary and boundary wall. In strip of 10 ft x 140 ft a row of trees has been planted.

Ravideep Gyl
CC, PPCB

Ravideep Gyl

Environmental Engineer
Punjab Pollution Control Board
Regional Office, Faridkot

⑤



Plate 6: Photograph showing Park Strip of 140 ft x 40 ft

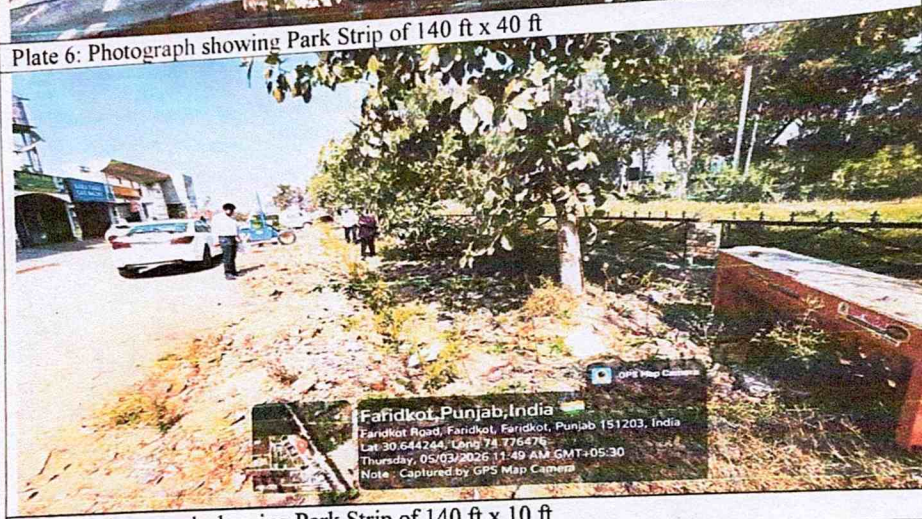

Plate 7: Photograph showing Park Strip of 140 ft x 10 ft

Plate - 6 & 7 shows the photographs of the park

Physical Measurement of the park is tabulated below:

S. No	Location of Park & Green Area	Dimensions as per approved map	Site verification	Remarks
1	Park opposite to SCO 4-10	140 ft x 50 ft	2 strips have been developed with the dimensions being 140ft x 50 ft	The physical dimensions of the approved layout plan.

4. Green Area Opposite to SCO 1-3

The site is located on the right side of the approach road to the Colony from the Faridkot – Kotkapura Road in front of SCO's adjacent to road and is not enclosed by any boundary wall. At site only growth of some plants was observed and has not been developed as park.

Ravideep Singh

6

Ravideep Singh
 Environmental Engineer
 Punjab Pollution Control Board
 Regional Office, Faridkot

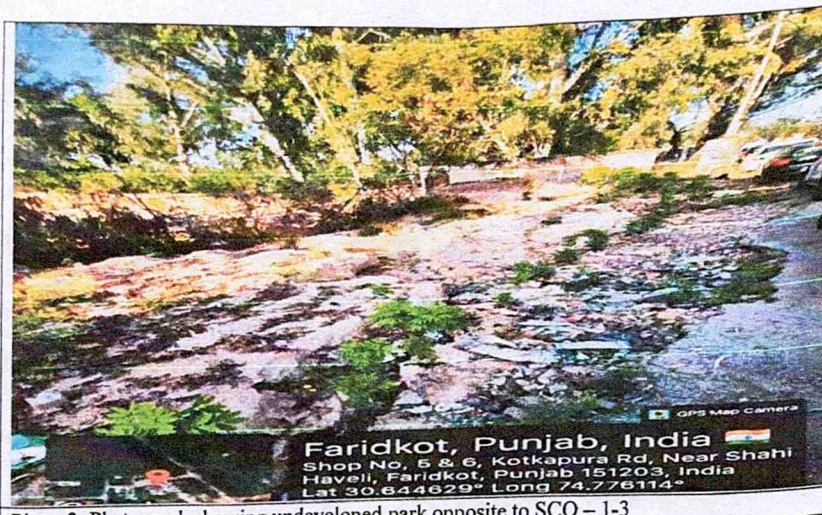

Plate- 8- Photograph showing undeveloped park opposite to SCO – 1-3

Plate – 8 shows the photographs of the park

Physical Measurement of the park is tabulated below:

S. No.	Location of Park & Green Area	Dimensions as per approved map	Site verification	Remarks
1	Park opposite to SCO 1-3	24'9" x 50' Triangular Site	A triangular strip measuring 24'9" x 50' having no plantation and only wild growth.	The physical measurements of the area are in consonance with the approved layout plan.

Farid Enclave (Phase-2), Kotkapura Road, Faridkot

1. Park Adjacent to Plot 177 and Opp to Plot 170-172

The park has been developed in common along with the park adjacent to Plot 50 and opposite to plot 43-45, Farid Enclave (Phase-I) without any boundary wall in between.

At site, the park has swings, green grass landscaping with trees planted along the boundary on three sides.

Ravideep Singh
EE POCB

⑦

Ravideep Singh
Environmental Engineer
Punjab Pollution Control Board
Regional Office, Faridkot

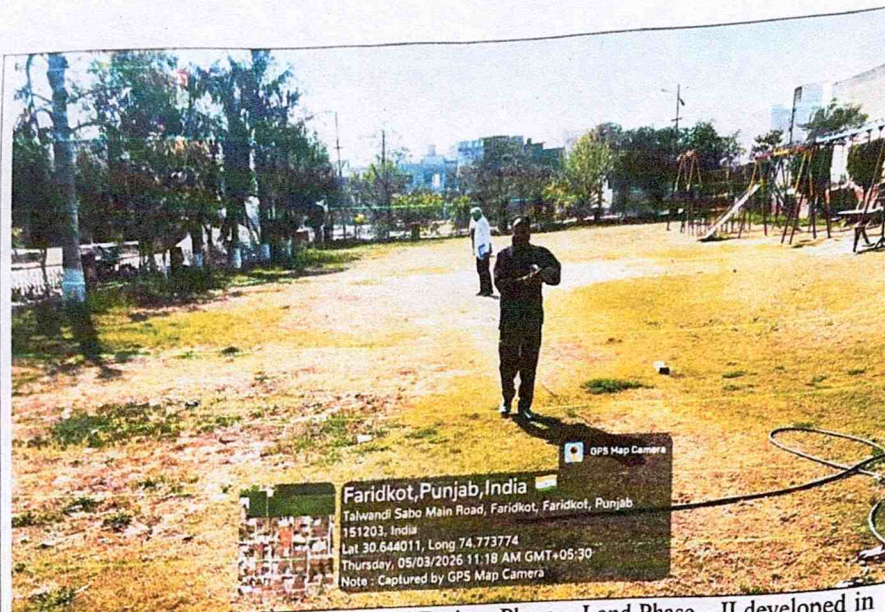

Plate-9- Photograph showing park of Farid Enclave Phase – I and Phase – II developed in common.

Plate – 9 shows the photographs of the park

Physical Measurements of the park is tabulated below:

S. No	Location of Park & Green Area	Dimensions as per approved map	Site verification	Remarks
1	Park adjacent to 177 and Opp to Plot 170-172 Farid Enclave (Phase II)	80 ft x 75 ft	Park has been developed in single land strip with other park of Farid Enclave Phase-I of same size.	The physical measurements of the park are in consonance with the approved layout plan.

2. Park Adjacent to School/Club site Phase-2 and Opp to Plot 111-112

The park has been developed in common along with the park Adjacent to School/ Club site and Opp to Plot 4, Farid Enclave (Phase-I) without any boundary wall in between.

The park is of dimensions 73 ft x 75 ft with a rectangular extension land strip bearing dimensions 60ft x 15 ft developed opposite to plot no 115 and 6 no. booths of Farid Enclave Phase-II. Trees alongwith wild grass growth were observed in extension land strip of dimension 60ft x 15ft with separate boundary. Vegetable cultivation is being carried out with few trees in other portion of park having dimension as 73 ft x 75 ft. This park stretch is in common with other park in Farid Enclave Phase-I without any boundary in between and having boundary on 2 sides and at the backside wall club. The access to the park was blocked with temporary wooden fencing.

Ravideep Singh
EE PPOB

(8)

Ravideep Singh
Environmental Engineer
Punjab Pollution Control Board
Regional Office, Faridkot

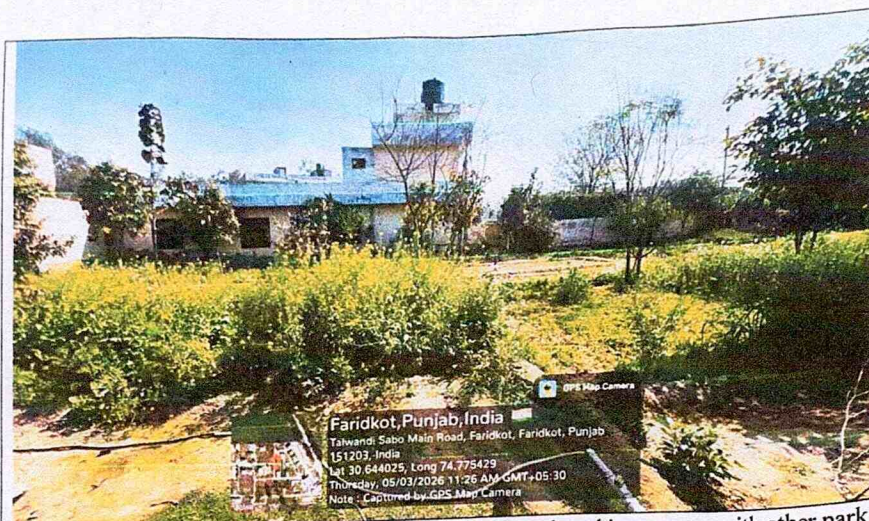

Plate 10: Park portion bearing dimensions 64 ft x 75 ft developed in common with other park in Farid Enclave Phase- II)



Plate- 11- Park Land strip bearing dimensions 60ft x 15ft Opp to Plot 115 & 6 no. booths of Farid Enclave (Phase II)

Plate - 10 & 11 shows the photographs of the park

Physical Measurements of the park is tabulated below:

S. No.	Location of Park & Green Area	Dimensions as per approved map	Site verification	Remarks
1	Park Adjacent to School/Club site Phase-II and Opp to Plot 115 of Farid Enclave (Phase II)	Land strip bearing dimensions 60ft x 15ft Opp to Plot 115 in front of booths in Farid Enclave (Phase II) +	land strips bearing dimensions 15ft x 60ft Opp to Plot 4-5 (Phase I) with trees and wild growth and land strip bearing dimensions 64 ft x 75 ft with trees and	The physical measurements of the park are in consonance with the approved layout plan.

Ravideep Singh
EE PCB

9

Ravideep Singh
Environmental Engineer
Punjab Pollution Control Board
Regional Office, Faridkot

		Land strip bearing dimensions 73 ft x 75 ft at backside of club.	vegetables cultivation	
--	--	--	------------------------	--

3. Green area Opposite to SCO 11-18

The park site is located between Faridkot-Kotkapura Road and SCO's (11-18) of the Farid Enclave (Phase-II) on the right side of the approach road to Farid Enclave Phase-II from Faridkot-Kotkapura Road. At site, the park area has been developed in single stretch with extension to the park opposite to SCO 4-10, Farid Enclave (Phase I) without any physical boundary in between.

The park has dimensions of 40ft x 140 ft strip and has a boundary wall on 2 sides. Green landscaping has been done along with tree plantation along the open boundary and boundary wall.



Plate -12- Photograph showing park of Farid Enclave Phase- II developed in front of SCO 11-18.

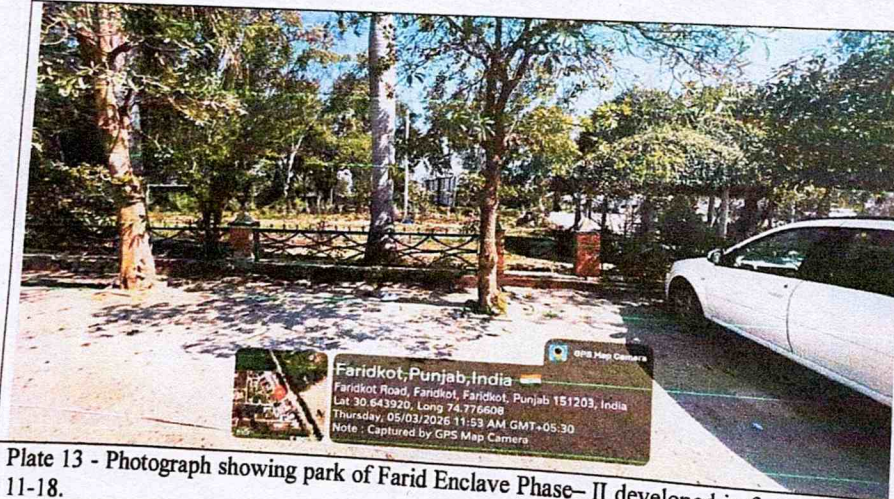

Plate 13 - Photograph showing park of Farid Enclave Phase- II developed in front of SCO 11-18.

Plate - 12 & 13 shows the photographs of the park

Physical Measurement of the park is tabulated below:

S. No	Location of Park & Green Area	Dimensions as per approved map	Site verification	Remarks
-------	-------------------------------	--------------------------------	-------------------	---------

Ravideep Singh
 CC PPCB

(10)

Ravideep Singh
 Environmental Engineer
 Punjab Pollution Control Board
 Regional Office, Faridkot

1	Park opposite to SCO 11-18	140 ft x 40 ft	Green area has been developed in Land Strip of dimensions 140 ft x 40 ft	The physical measurements of the park are in consonance with the approved layout plan.
---	----------------------------	----------------	--	--

4. Park Between Plot 106 & 115

The area has not been developed as a park and wild growth was observed at site. The site of park falls between Plot No 106 & 115 of Farid Enclave Phase-II. Foundation of poles of HT wires and electricity transformer poles exists at site with wild growth.



Plate-14- Photograph showing park of Farid Enclave Phase- II developed in between plot no. 106 and 115.

Plate - 14 shows the photographs of the park

Physical Measurement of the park is tabulated below:

S. No.	Location of Park & Green Area	Dimensions as per approved map	Site verification	Remarks
1	Park between plot no. 106 and 115	54 ft x 75 ft	Green Area could not be measured in absence of clear demarcation however no encroachment was observed in the park except for erection of electricity poles	The physical measurements of the park are in consonance with the approved layout plan.

5. Park opposite to SCO 19-24 where Hotel Shahi Haveli is situated

As per the layout plan approved vide drawing No. NM1H dated 25.10.2021 the park was proposed to be developed in L shaped layout area (740.78 sq. yds) in front of SCO's no. 19 to 24 of Farid Enclave (Phase-II).

Ravideep Singh
EG PPCB

Ravideep Singh
Environmental Engineer
Punjab Pollution Control Board,
Regional Office, Faridkot

The 6 SCOs numbered as 19 to 24 of Farid Enclave (Phase-II) have been developed as Hotel Shahi Haveli and park in-front of it has been developed with grass and ornamental plants. The park with area of 740.78 sq. yards, has various swings installed with moveable seating arrangement of tables and chairs. Entry to Hotel Shahi Haveli has been provided through the park's central area with pucca flooring (8 ft x 40 ft). Toilets for men and women measuring 28.5 ft x 11.10 ft have also been developed and established in the corner area of the park with passage of pucca flooring measuring 6 ft x40 ft to approach the toilets. However, overall dimensions of the park are same as per the approved layout plan with hotel approach pavement, toilets, and toilet approach pavement covering an area of 876.35 sq. ft. The toilets are used as a public utility. The entrance pavement and the toilet pavement divide the park into 3 green sections.



Plate- 15- Photograph showing park area with swings and tables and chairs of Hotel Shahi Haveli

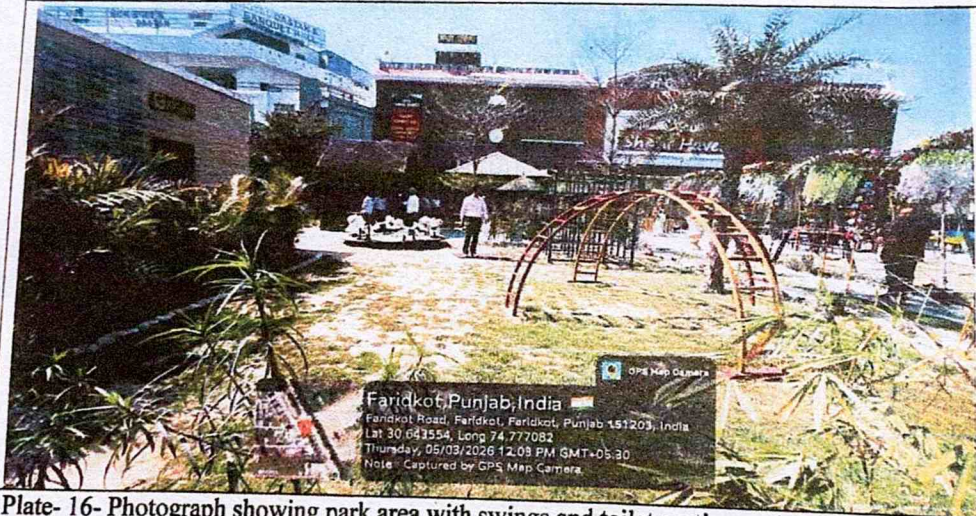

Plate- 16- Photograph showing park area with swings and toilet section on left side

Ravinder Singh
EE PPCB

Ravinder Singh
Environmental Engineer
Punjab Pollution Control Board
Regional Office, Faridkot



Plate 17- Photograph showing entrance (8 ft wide) to Hotel Shahi Haveli through park

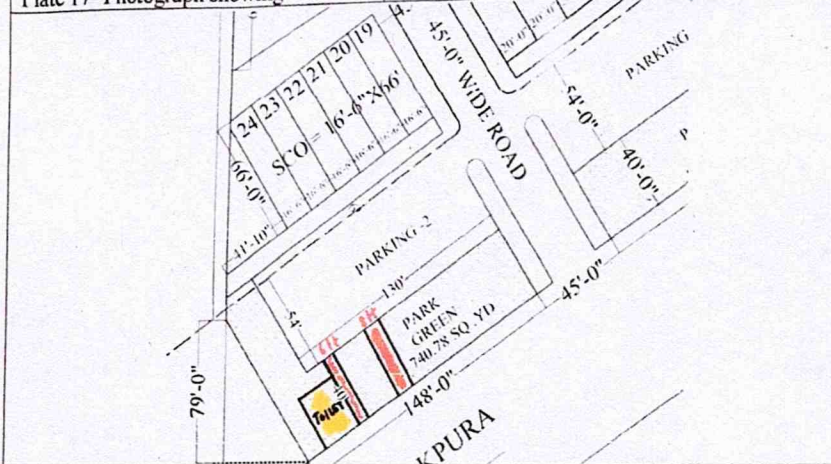

Plate 18 – Map showing location of entrance to the Hotel (8 ft wide), toilet pavement (6 ft wide) and toilet in the park

Plate – 15, 16, 17 and 18 shows the photographs of the park

Physical Measurement of the park is tabulated below:

S. No.	Location of Park & Green Area	Dimensions as per approved map	Site verification	Remarks
1	Park opposite to SCO 19-24	Having land area @740.78 sq. yds.	Out of total area of park 560 sq. ft. (2 nos. pavement 8 ft wide and 6 ft wide of length 40 ft have been provided and a toilet section 316.35 sq. ft. approx. (28.5 ft. x 11.10 ft.) has been provided.	

Ravideep Singh
EE, PPCB

13 *Ravideep Singh*
Environmental Engineer
Punjab Pollution Control Board
Regional Office, Faridkot

Recommendations:

1. Encroachment over an area of 876.35 sq. feet of the park (in front of SCO's numbered 19 to 24) by Hotel Shahi Haveli (M/s Farid Enclave Phase II), the measurements of which are given below:
 - i) Entrance to Hotel Shahi Haveli- 8ft x 40 ft: The entrance path may be closed along with the removal of hoarding structure of Hotel Shahi Haveli to restore the integrity of the park.
 - ii) Toilets for Men and Women – 28.5 ft x 11.10 ft: Are used as a public utility.
 - iii) Passage provided for toilets – 6ft x 40 ft: Is used to access the public toilets.
2. A committee comprising of the officers/officials of BDA with members of residents of Colony (Farid Enclave I & II) may be constituted to ensure that the green area of the residential colony (Farid Enclave I & II) is not encroached upon by anyone in future.

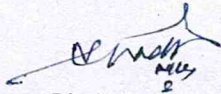

District Town Planner
Faridkot



Deputy Superintendent of Police
Faridkot



Tehsildar
Faridkot

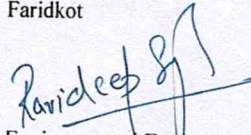

Environmental Engineer
Punjab Pollution Control Board
Faridkot



Environmental Engineer
Punjab Pollution Control Board
Regional Office, Faridkot

704
Annexure - A

Item No. 05

Court No. 2

**BEFORE NATIONAL GREEN TRIBUNAL
PRINCIPAL BENCH, NEW DELHI**

Original Application No. 665/2023
(I.A. No. 92/2025, I.A. No. 504/2024, I.A. No. 582/2024, I.A. No.
659/2024, I.A. No. 661/2024)

Nirmal Singh

Applicant

Versus

State of Punjab & Ors.

Respondents

Date of hearing: 24.02.2026

**CORAM: HON'BLE MR. JUSTICE ARUN KUMAR TYAGI, JUDICIAL MEMBER
HON'BLE MR. ISHWAR SINGH, EXPERT MEMBER**

Applicant: Applicant in Person.

Respondents: Mr. Dipankar Agarwal, Advocate for respondents no. 1 and 2.
Mr. Udit Vaghela and Mr. Arjun Baliyan, Advocates for respondent no. 3.
Mr. Ravideep Singla, Environmental Engineer, Regional Office, Faridkot.
Mr. Bikramjeet Singh, Assistant Environmental Engineer.
Ms. Namrata Chandorkar, Advocate for respondent no. 4.
Mr. Shubham Bhalla, Advocate for respondent no.5.
Mr. Navjot Singh, Divisional Engineer (Public Health) BDA.

ORDER

1. The applicant-President of Farid Enclave Welfare Society has sent the present letter petition which has been treated and registered as original application complaining about non-operation of STP and sale of land designated for greenbelt/disposal of waste water by the Project Proponent-M/s. Farid Colonizers.

2. Vide order dated 11.01.2024, notices were ordered to be issued to respondents no. 1 to 3 thereby impleaded.

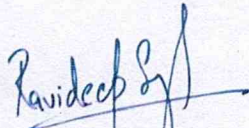
EG PPCB

Environmental Engineer
Punjab Pollution Control Board
Regional Office, Faridkot

3. In the course of hearing, reports/replies were filed by the respondents- Additional Secretary, Department of Science, Technology and Environment, Government of Punjab and DC, Faridkot and PPCB.
4. In the course of hearing, Project Proponent-M/s. Farid Colonizers, Bathinda Development Authority, Sanjay Tangri and Smt. Kaamna Tangri were impleaded as Respondents No. 4 to 7.
5. Pursuant to notice replies were filed by Respondent No. 4-Project Proponent (M/s. Farid Colonizers) and Respondent No. 5-Bathinda Development Authority.
6. The applicant-Farid Enclave Welfare Society has alleged that STP never worked and that land of green belt has been sold by Respondent No. 04-Project Proponent (M/s. Farid Colonizers).
7. This Tribunal observed in its order dated 29.11.2024 that Bathinda Development Authority is trying to give up its responsibility of maintaining STP in the colony in question and ordered personal appearance of the Chief Administrator, Bathinda Development Authority.
8. Reply dated 11.12.2024 was filed by Respondent No. 5-Bathinda Development Authority.
9. In its reply Respondent No. 5-Bathinda Development Authority had referred to section 5 (13) of the Punjab Apartments and Property Regulation Act, 1995 which imposes the responsibility on the promotor to maintain and upkeep all the roads, open spaces, public parks and public health services for a period of five years from the date of issue of completion certificate or till the date of transfer free of cost to the State Government or the local authority. The proviso to above sub section provides that after

Rawideep Sg/S
EE PPCB

Rawideep Sg/S
Environmental Engineer
Punjab Pollution Control Board
Regional Office, Faridkot

completion of the development works in the colony in all respects, the competent authority may allow the promoters to hand over the maintenance of the infrastructure and services to the association of the residents formed under section 17 A of the above said Act upon which transfer the association shall be responsible for the management, maintenance and upkeep of common areas, infrastructure and common services of the colony. In case of non-compliance license of the promoters can be cancelled.

10. Respondent No. 4-M/s. Farid Colonizer has claimed to have transferred the colony with STP to the Punjab Urban Planning and Development Authority vide conveyance deed dated 17.03.2017.

11. In view of disputed factual position regarding transfer of STP by respondent no.4- M/s. Farid Colonizers to the Punjab Urban Planning & Development Authority (PUDA) and respondent no. 5- Bhatinda Development Authority, this Tribunal directed respondent no. 5 to continue to operate and maintain STP in question till final adjudication of the original application or till further orders to the contrary.

12. In view of the relevant statutory provisions, the STP is to be operated and maintained by RWAs and therefore, the question as to constitution and operation of RWAs arises in the present case. The primary duty of operation and maintenance of the STP lies on respondent no. 4-project proponent who has to satisfy this Tribunal regarding due discharge of its statutory and contractual obligations regarding construction of operation and maintenance of STP and transfer to local authorities for ultimately being handed over to the RWAs.

Ravideep Singh
EE PPCB

Ravideep Singh
Environmental Engineer
Punjab Pollution Control Board
Regional Office, Faridkot

13. Respondent no. 4 is directed to file an affidavit giving particulars of all the owners of residential, commercial properties with details regarding constitution and operation of RWAs in respect thereof.
14. Respondent no. 5 is directed to file an affidavit giving cost of operation and maintenance of STP so that the quantum of expenses to be incurred by respective RWAs can be tentatively worked out.
15. The District Magistrate, Bathinda and Punjab Pollution Control Board are directed to issue appropriate directions for constitution of RWAs if not already constituted in respect to all residential and commercial properties. The completion certificate, if any, issued to respondent no. 4 will be subject to compliance by respondent no. 4 with its statutory and contractual obligations.
16. The affidavits as directed above may be filed at least one day before the next date of hearing fixed.
17. In the course of hearing, the Applicant has submitted that the part of green belt has been encroached upon by the owner of Shahi Haveli.
18. The Regional Officer, PPCB is directed to visit the site of the green belt and to submit his report regarding encroachment on green belt. In the eventuality of any encroachment being found, the Regional Officer, PPCB shall send copy of the report to the District Magistrate cum Deputy Commissioner, Bathinda who shall initiate appropriate proceedings for demolition of unauthorized constructions/removal of encroachment immediately on receipt thereof and file his action taken report at least before one day before the next date of hearing fixed.

Ravideep Singh
EE PPCB

Ravideep Singh
Environmental Engineer
Punjab Pollution Control Board
Regional Office, Faridkot

19. The District Magistrate cum Deputy Commissioner, Bathinda and Superintendent of Police, Bathinda are directed to provide requisite assistance to the Applicant.
20. List on 08.04.2026 for further hearing.
21. A copy of this order may be sent to the District Magistrate cum Deputy Commissioner, Bathinda and Superintendent of Police, Bathinda by email for requisite compliance.

Arun Kumar Tyagi, JM

Ishwar Singh, EM

February 24th, 2026
Original Application No. 665/2023
(I.A. No. 92/2025, I.A. No. 504/2024, I.A. No. 582/2024, I.A. No.
659/2024, I.A. No. 661/2024)
AB

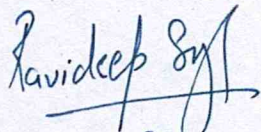
EE PPCB

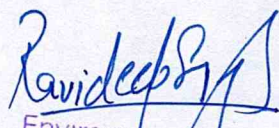
Environmental Engineer
Punjab Pollution Control Board
Regional Office, Faridkot

709
Annexure - B



Office of the Deputy Commissioner-cum-Distt. Magistrate, Faridkot
CEA Branch

No/144:CEA

Dated :03/03/2026

To,

1. Senior Superintendent Of Police, Faridkot
2. Additional Deputy Commissioner (G), Faridkot
3. Additional Chief Administrator, Bathinda Development Authority, Bathinda
4. Environmental Engineer, Punjab Pollution Control Board, Faridkot
5. District Town Planner, Faridkot
6. Tehsildar, Faridkot

Subject: "NGT OA No 665/2023 regarding Nirmal Singh v/s Farid Colonizers
and Others order dated 24.02.2026"

In regards to above Hon'ble National Green Tribunal, New Delhi has directed Regional Officer, PPCB to visit the site of Farid Enclave located on Kotkapura Road, Faridkot and submit his report regarding the encroachment of Green Belt to office of the undersigned.

As such, to assist Regional Officer, PPCB, Faridkot a committee is constituted with following members:

1. Environmental Engineer, Punjab Pollution Control Board, Faridkot - Chairman
2. District Town Planner, Faridkot - Member
3. DSP, Faridkot - Member
4. Tehsildar, Faridkot - Member

Above committee shall visit the site and submit report regarding encroachment of Green Belt along with its recommendations within 3 days.

Deputy Commissioner
Faridkot

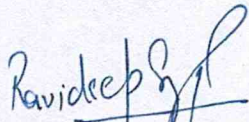
cc PPCB

Environmental Engineer
Punjab Pollution Control Board
Regional Office, Faridkot

CS CamScanner

Amended - C

**RESIDENTIAL COLONY NAMELY
'FARID ENCLAVE' PHASE - I
ON KOTKAPURA ROAD AT FARIDKOT.**

PROMOTER:
M/S. FARID COLONIES, KOTKAPURA ROAD, FARIDKOT.
3.327 ACRES (AT 000.17 S.Y.S)
(APPROX)

DETAIL OF RESIDENTIAL PLOTS.

S.NO.	PLOT NO.	SIZE IN SQ. YDS.	AREA OF EACH PLOT IN SQ. YDS.	NO. OF PLOTS.	TOTAL AREA IN SQ. YDS.
			477.75	10	4777.50
1	105, 800	43.0 x 100.0	466.67	2	933.34
2	6, 7	42.0 x 100.0	420.00	9	3780.00
3	13, 17, 24, 102	36.0 x 80.0	288.00	4	1152.00
4	18, 23	35.0 x 80.0	280.00	1	280.00
5	19, 20, 22	37.0 x 80.0	296.00	6	1776.00
6	28	36.0 x 80.0	288.00	15	4320.00
7	29, 30, 41, 104, 4	25.0 x 80.0	200.00	27	5400.00
8	31, 40, 45, 104, 5	30.0 x 80.0	240.00	3	720.00
9	50, 59, 61, 106, 6, 6, 6, 70, 72, 70, 77, 79, 80.	30.0 x 80.0	240.00	3	720.00
10	67, 68, 78	35.0 x 75.0	262.50	1	262.50
11	71	25.0 x 75.0	187.50	12	2250.00
12	81, 70, 82	24.0 x 80.0	192.00	2	384.00
13	83, 84	22.0 x 80.0	176.00	2	352.00
			TOTAL	94	25107.27

STATEMENT OF AREA.

AREA UNDER RESIDENTIAL PLOT	25107.2750	5.185	100.00
AREA UNDER COMMERCIAL PLOT	1807.24	0.403	100.00
Total Commercial Area 26944.71 = 5.588			
AREA UNDER NURSERY SCHOOL	978.10	0.216	100.00
WATER WORKS LEAF	844.08	0.187	100.00
S.T.P.	882.67	0.195	100.00
PARKING, GUARD	2146.52	0.443	100.00
ROADS, PARKING & STAMEN	16335.02	3.376	100.00
TOTAL	47800.17	9.837	100.00

DETAIL OF PARKING

PARKING FOR SC00 13 14 15	500' 20' x 50' - 7000	500' 10' x 60' - 3000	PARKING FOR BOOTH 14
140 x 80 = 11200 SQ FT	49 x 60 = 2940 SQ	1000 x 50 = 50000	6000 x 100 = 600000
S.A.D. 100 x 10	TOTAL FLOOR AREA = 141400 SQ FT	6000 x 50 = 300000	6000 x 100 = 600000
TOTAL FLOOR AREA = 234200 SQ FT	TOTAL FLOOR AREA = 141400 SQ FT	6000 x 50 = 300000	6000 x 100 = 600000
CAR SPACES REQUIRED = 294200 / 100 = 2942	+ 400 = 3342	6000 x 50 = 300000	6000 x 100 = 600000
POR PARKING = 3342	TOTAL = 3342	6000 x 50 = 300000	6000 x 100 = 600000
1000 x 100 = 100000	TOTAL = 3342	6000 x 50 = 300000	6000 x 100 = 600000
PARKING AREA REQUIRED = 400000 / 100 = 4000	PARKING AREA PROVIDED = 3342	6000 x 50 = 300000	6000 x 100 = 600000
1000 x 100 + 400 x 100 = 140000	300000	6000 x 50 = 300000	6000 x 100 = 600000
6000.00 + 10000.00 + 18000.00 = 34000.00 SQ FT		6000 x 50 = 300000	6000 x 100 = 600000

DATE: 9/2/14
 LAY: [Signature]
 ARCHITECT: TOWN PLANNING
 17, 13/10, SECTION 44-N

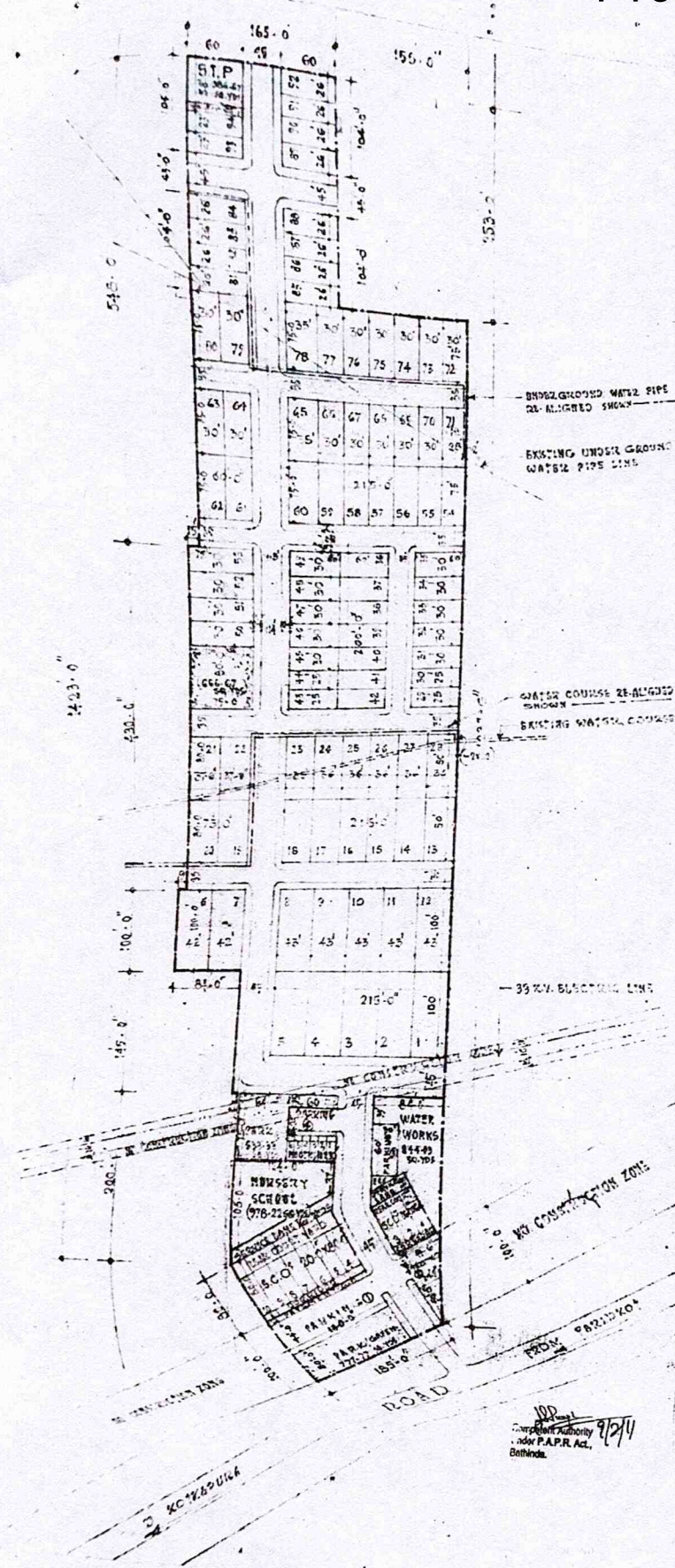

Ravideep Singh
 EE PPICB

Ravideep Singh
 Environmental Engineer
 Punjab Pollution Control Board
 Regional Office, Faridkot

PROPOSED RESIDENTIAL COLONY PHASE-II ON FARM ENCLAVE ROAD AT FARIDKOT KOTKAPURA ROAD AT FARIDKOT

PROMOTER
M/S BABA FARID COLONISERS, KOTKAPURA ROAD, FARIDKOT

TOTAL AREA OF THE SCHEME 9.661 ACRES (47823 SQ. YDS.) APPROX.

SCHEME BOUNDARY.

DETAIL OF RESIDENTIAL PLOTS

SERIAL NO.	SIZE IN FEET	AREA OF EACH PLOT IN SQ. YDS.	NO. OF PLOTS	TOTAL AREA IN SQ. YDS.	
1	30.0 x 75.0	225.00	1	225.00	
2	30.0 x 75.0	225.00	12	2700.00	
3	30.0 x 60.0	180.00	24	4320.00	
4	45.0 x 100.0	450.00	4	1800.00	
5	45.0 x 75.0	337.50	1	337.50	
6	30.0 x 75.0	225.00	4	900.00	
7	30.0 x 75.0	225.00	1	225.00	
8	45.0 x 75.0	337.50	2	675.00	
9	30.0 x 60.0	180.00	10	1800.00	
10	30.0 x 75.0	225.00	1	225.00	
11	30.0 x 75.0	225.00	1	225.00	
12	30.0 x 75.0	225.00	1	225.00	
13	30.0 x 75.0	225.00	4	900.00	
14	30.0 x 75.0	225.00	27	6075.00	
15	30.0 x 75.0	225.00	2	450.00	
16	30.0 x 75.0	225.00	1	225.00	
17	30.0 x 75.0	225.00	1	225.00	
18	30.0 x 75.0	225.00	1	225.00	
TOTAL				104	22875.00

STATEMENT OF AREAS

AREA UNDER RESIDENTIAL PLOTS	22875.00	22875.00
AREA UNDER OPEN SPACES	1000.00	1000.00
AREA UNDER PARKING	1000.00	1000.00
AREA UNDER SERVICE ROAD	1000.00	1000.00
AREA UNDER WATER TOWER	1000.00	1000.00
AREA UNDER WATER TREATMENT PLANT	1000.00	1000.00
TOTAL AVAILABLE AREA	26875.00	26875.00

DETAIL OF PARKING

TYPE OF VEHICLE	NO. OF SPACES	AREA IN SQ. YDS.
Two Wheeler	100	1000.00
Four Wheeler	50	1000.00
Auto Rickshaw	100	1000.00
Tricycle	100	1000.00
Motor Cycle	100	1000.00
Other	100	1000.00
TOTAL	500	5000.00

PROMOTER
LAYOUT
DATE

RAJ KUMAR WADHAWAN
B.Arch MCRP AITP
Reg. No. GA/2001/27809
ARCHITECT

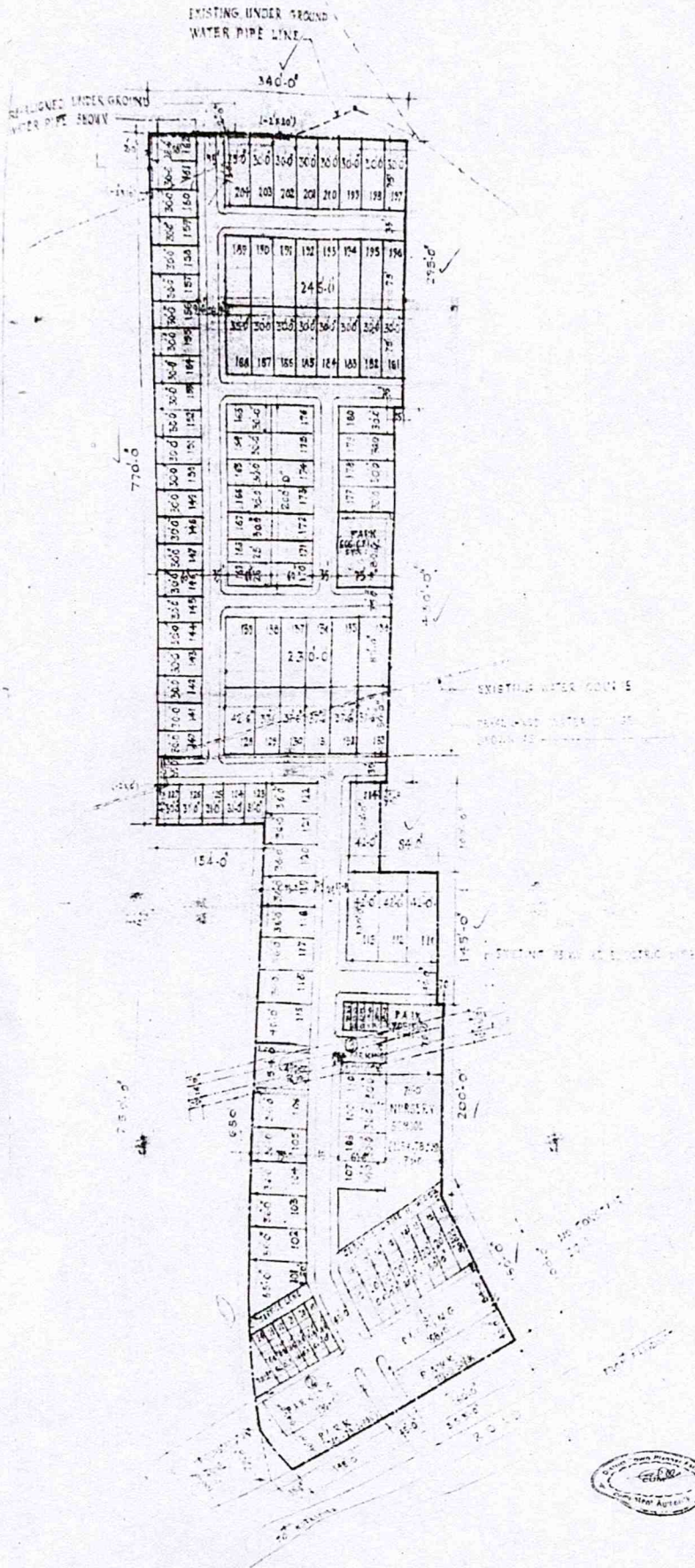

Ravideep Singh
Environmental Engineer
Punjab Pollution Control Board
Regional Office, Faridkot

REVISED RESIDENTIAL COLONY FARID ENCLAVE COMBINED PHASE-I & II ON KOTAKPURA ROAD AT FARIDKOT

PROMOTER :- M/S BABA FARID COLONISERS, KOTAKPURA ROAD, FARIDKOT

TOTAL AREA OF THE SCHEME PH-I - 9.837 ACRES OR 17609.17 SQ. YARD
TOTAL AREA OF THE SCHEME PH-II - 9.861 ACRES OR 17823.00 SQ. YARD

DETAILS OF RESIDENCY PLOTS - PHASE-I

SR. NO.	PILOT NOS.	SIZE INTL.	AREA OF EACH PLOT IN SQ. YARD	NO. OF PLOTS	TOTAL AREA IN SQ. YARD
1.	110, 3, 8, 10, 11	11'-0" x 100'-0"	1100.00	10	11000.00
2.	11	42'-0" x 100'-0"	4200.00	1	4200.00
3.	13 to 17, 24 to 27	15'-0" x 50'-0"	750.00	15	11250.00
4.	18 to 22	15'-0" x 50'-0"	750.00	5	3750.00
5.	23	15'-0" x 50'-0"	750.00	1	750.00
6.	29, 30, 41 to 44	30'-0" x 50'-0"	1500.00	4	6000.00
7.	11, 10, 40, 42, 103 to 49	30'-0" x 50'-0"	1500.00	12	18000.00
8.	50 to 59 to 61 to 64	30'-0" x 75'-0"	2250.00	4	9000.00
9.	66 to 70, 72 to 77, 79 to 80	30'-0" x 75'-0"	2250.00	11	24750.00
10.	81 to 85	30'-0" x 75'-0"	2250.00	5	11250.00
11.	86	30'-0" x 75'-0"	2250.00	1	2250.00
12.	87	30'-0" x 75'-0"	2250.00	1	2250.00
13.	88	30'-0" x 75'-0"	2250.00	1	2250.00
14.	89	30'-0" x 75'-0"	2250.00	1	2250.00
15.	90	30'-0" x 75'-0"	2250.00	1	2250.00
16.	91	30'-0" x 75'-0"	2250.00	1	2250.00
17.	92	30'-0" x 75'-0"	2250.00	1	2250.00
18.	93	30'-0" x 75'-0"	2250.00	1	2250.00
19.	94	30'-0" x 75'-0"	2250.00	1	2250.00
20.	95	30'-0" x 75'-0"	2250.00	1	2250.00
21.	96	30'-0" x 75'-0"	2250.00	1	2250.00
22.	97	30'-0" x 75'-0"	2250.00	1	2250.00
23.	98	30'-0" x 75'-0"	2250.00	1	2250.00
24.	99	30'-0" x 75'-0"	2250.00	1	2250.00
25.	100	30'-0" x 75'-0"	2250.00	1	2250.00
26.	101	30'-0" x 75'-0"	2250.00	1	2250.00
27.	102	30'-0" x 75'-0"	2250.00	1	2250.00
28.	103	30'-0" x 75'-0"	2250.00	1	2250.00
29.	104	30'-0" x 75'-0"	2250.00	1	2250.00
30.	105	30'-0" x 75'-0"	2250.00	1	2250.00
31.	106	30'-0" x 75'-0"	2250.00	1	2250.00
32.	107	30'-0" x 75'-0"	2250.00	1	2250.00
33.	108	30'-0" x 75'-0"	2250.00	1	2250.00
34.	109	30'-0" x 75'-0"	2250.00	1	2250.00
35.	110	30'-0" x 75'-0"	2250.00	1	2250.00
36.	111	30'-0" x 75'-0"	2250.00	1	2250.00
37.	112	30'-0" x 75'-0"	2250.00	1	2250.00
38.	113	30'-0" x 75'-0"	2250.00	1	2250.00
39.	114	30'-0" x 75'-0"	2250.00	1	2250.00
40.	115	30'-0" x 75'-0"	2250.00	1	2250.00
41.	116	30'-0" x 75'-0"	2250.00	1	2250.00
42.	117	30'-0" x 75'-0"	2250.00	1	2250.00
43.	118	30'-0" x 75'-0"	2250.00	1	2250.00
44.	119	30'-0" x 75'-0"	2250.00	1	2250.00
45.	120	30'-0" x 75'-0"	2250.00	1	2250.00
46.	121	30'-0" x 75'-0"	2250.00	1	2250.00
47.	122	30'-0" x 75'-0"	2250.00	1	2250.00
48.	123	30'-0" x 75'-0"	2250.00	1	2250.00
49.	124	30'-0" x 75'-0"	2250.00	1	2250.00
50.	125	30'-0" x 75'-0"	2250.00	1	2250.00
51.	126	30'-0" x 75'-0"	2250.00	1	2250.00
52.	127	30'-0" x 75'-0"	2250.00	1	2250.00
53.	128	30'-0" x 75'-0"	2250.00	1	2250.00
54.	129	30'-0" x 75'-0"	2250.00	1	2250.00
55.	130	30'-0" x 75'-0"	2250.00	1	2250.00
56.	131	30'-0" x 75'-0"	2250.00	1	2250.00
57.	132	30'-0" x 75'-0"	2250.00	1	2250.00
58.	133	30'-0" x 75'-0"	2250.00	1	2250.00
59.	134	30'-0" x 75'-0"	2250.00	1	2250.00
60.	135	30'-0" x 75'-0"	2250.00	1	2250.00
61.	136	30'-0" x 75'-0"	2250.00	1	2250.00
62.	137	30'-0" x 75'-0"	2250.00	1	2250.00
63.	138	30'-0" x 75'-0"	2250.00	1	2250.00
64.	139	30'-0" x 75'-0"	2250.00	1	2250.00
65.	140	30'-0" x 75'-0"	2250.00	1	2250.00
66.	141	30'-0" x 75'-0"	2250.00	1	2250.00
67.	142	30'-0" x 75'-0"	2250.00	1	2250.00
68.	143	30'-0" x 75'-0"	2250.00	1	2250.00
69.	144	30'-0" x 75'-0"	2250.00	1	2250.00
70.	145	30'-0" x 75'-0"	2250.00	1	2250.00
71.	146	30'-0" x 75'-0"	2250.00	1	2250.00
72.	147	30'-0" x 75'-0"	2250.00	1	2250.00
73.	148	30'-0" x 75'-0"	2250.00	1	2250.00
74.	149	30'-0" x 75'-0"	2250.00	1	2250.00
75.	150	30'-0" x 75'-0"	2250.00	1	2250.00
76.	151	30'-0" x 75'-0"	2250.00	1	2250.00
77.	152	30'-0" x 75'-0"	2250.00	1	2250.00
78.	153	30'-0" x 75'-0"	2250.00	1	2250.00
79.	154	30'-0" x 75'-0"	2250.00	1	2250.00
80.	155	30'-0" x 75'-0"	2250.00	1	2250.00
81.	156	30'-0" x 75'-0"	2250.00	1	2250.00
82.	157	30'-0" x 75'-0"	2250.00	1	2250.00
83.	158	30'-0" x 75'-0"	2250.00	1	2250.00
84.	159	30'-0" x 75'-0"	2250.00	1	2250.00
85.	160	30'-0" x 75'-0"	2250.00	1	2250.00
86.	161	30'-0" x 75'-0"	2250.00	1	2250.00
87.	162	30'-0" x 75'-0"	2250.00	1	2250.00
88.	163	30'-0" x 75'-0"	2250.00	1	2250.00
89.	164	30'-0" x 75'-0"	2250.00	1	2250.00
90.	165	30'-0" x 75'-0"	2250.00	1	2250.00
91.	166	30'-0" x 75'-0"	2250.00	1	2250.00
92.	167	30'-0" x 75'-0"	2250.00	1	2250.00
93.	168	30'-0" x 75'-0"	2250.00	1	2250.00
94.	169	30'-0" x 75'-0"	2250.00	1	2250.00
95.	170	30'-0" x 75'-0"	2250.00	1	2250.00
96.	171	30'-0" x 75'-0"	2250.00	1	2250.00
97.	172	30'-0" x 75'-0"	2250.00	1	2250.00
98.	173	30'-0" x 75'-0"	2250.00	1	2250.00
99.	174	30'-0" x 75'-0"	2250.00	1	2250.00
100.	175	30'-0" x 75'-0"	2250.00	1	2250.00
101.	176	30'-0" x 75'-0"	2250.00	1	2250.00
102.	177	30'-0" x 75'-0"	2250.00	1	2250.00
103.	178	30'-0" x 75'-0"	2250.00	1	2250.00
104.	179	30'-0" x 75'-0"	2250.00	1	2250.00
105.	180	30'-0" x 75'-0"	2250.00	1	2250.00
106.	181	30'-0" x 75'-0"	2250.00	1	2250.00
107.	182	30'-0" x 75'-0"	2250.00	1	2250.00
108.	183	30'-0" x 75'-0"	2250.00	1	2250.00
109.	184	30'-0" x 75'-0"	2250.00	1	2250.00
110.	185	30'-0" x 75'-0"	2250.00	1	2250.00
111.	186	30'-0" x 75'-0"	2250.00	1	2250.00
112.	187	30'-0" x 75'-0"	2250.00	1	2250.00
113.	188	30'-0" x 75'-0"	2250.00	1	2250.00
114.	189	30'-0" x 75'-0"	2250.00	1	2250.00
115.	190	30'-0" x 75'-0"	2250.00	1	2250.00
116.	191	30'-0" x 75'-0"	2250.00	1	2250.00
117.	192	30'-0" x 75'-0"	2250.00	1	2250.00
118.	193	30'-0" x 75'-0"	2250.00	1	2250.00
119.	194	30'-0" x 75'-0"	2250.00	1	2250.00
120.	195	30'-0" x 75'-0"	2250.00	1	2250.00
121.	196	30'-0" x 75'-0"	2250.00	1	2250.00
122.	197	30'-0" x 75'-0"	2250.00	1	2250.00
123.	198	30'-0" x 75'-0"	2250.00	1	2250.00
124.	199	30'-0" x 75'-0"	2250.00	1	2250.00
125.	200	30'-0" x 75'-0"	2250.00	1	2250.00
126.	201	30'-0" x 75'-0"	2250.00	1	2250.00
127.	202	30'-0" x 75'-0"	2250.00	1	2250.00
128.	203	30'-0" x 75'-0"	2250.00	1	2250.00
129.	204	30'-0" x 75'-0"	2250.00	1	2250.00
130.	205	30'-0" x 75'-0"	2250.00	1	2250.00
131.	206	30'-0" x 75'-0"	2250.00	1	2250.00
132.	207	30'-0" x 75'-0"	2250.00	1	2250.00
133.	208	30'-0" x 75'-0"	2250.00	1	2250.00
134.	209	30'-0" x 75'-0"	2250.00	1	2250.00
135.	210	30'-0" x 75'-0"	2250.00	1	2250.00
136.	211	30'-0" x 75'-0"	2250.00	1	2250.00
137.	212	30'-0" x 75'-0"	2250.00	1	2250.00
138.	213	30'-0" x 75'-0"	2250.00	1	2250.00
139.	214	30'-0" x 75'-0"	2250.00	1	2250.00
140.	215	30'-0" x 75'-0"	2250.00	1	2250.00
141.	216	30'-0" x 75'-0"	2250.00	1	2250.00
142.	217	30'-0" x 75'-0"	2250.00	1	2250.00
143.	218	30'-0" x 75'-0"	2250.00	1	2250.00
144.	219	30'-0" x 75'-0"	2250.00	1	2250.00
145.	220	30'-0" x 75'-0"	2250.00	1	2250.00
146.	221	30'-0" x 75'-0"	2250.00	1	2250.00
147.	222	30'-0" x 75'-0"	2250.00	1	2250.00
148.	223	30'-0" x 75'-0"	2250.00	1	2250.00
149.	224	30'-0" x 75'-0"	2250.00	1	2250.00
150.	225	30'-0" x 75'-0"	2250.00	1	2250.00
151.	226	30'-0" x 75'-0"	2250.00	1	2250.00
152.	227	30'-0" x 75'-0"	2250.00	1	2250.00
153.	228	30'-0" x 75'-0"	2250.00	1	2250.00
154.	229	30'-0" x 75'-0"	2250.00	1	2250.00
155.	230	30'-0" x 75'-0"	2250.00	1	2250.00
156.	231	30'-0" x 75'-0"	2250.00	1	2250.00
157.	232	30'-0" x 75'-0"	2250.00	1	2250.00
158.	233	30'-0" x 75'-0"	2250.00	1	2250.00
159.	234	30'-0" x 75'-0"	2250.00	1	2250.00
160.	235	30'-0" x 75'-0"	2250.00	1	2250.00
161.	236	30'-0" x 75'-0"	2250.00	1	2250.00
162.	237	30'-0" x 75'-0"	2250.00	1	2250.00
163.	238	30'-0" x 75'-0"	2250.00	1	2250.00
164.	239	30'-0" x 75'-0"	2250.00	1	2250.00
165.	240	30'-0" x 75'-0"	2250.00	1	2250.00
166.	241	30'-0" x 75'-0"	2250.00	1	2250.00
167.	242	30'-0" x 75'-0"	2250.00	1	2250.00
168.	243	30'-0" x 75'-0"	2250.00	1	2250.00
169.	244	30'-0" x 75'-0"	2250.00	1	2250.00
170.	245	30'-0" x 75'-0"	2250.00	1	2250.00
171.	246	30'-0" x 75'-0"	2250.00	1	2250.00
172.	247	30'-0" x 75'-0"	2250.00	1	2250.00
173.	248	30'-0" x 75'-0"	2250.00	1	2250.00
174.	249	30'-0" x 75'-0"	2250.00	1	2250.00
175.	250	30'-0" x 75'-0"	2250.00	1	2250.00
176.	251	30'-0" x 75'-0"	2250.00	1	2250.00
177.	252	30'-0" x 75'-0"	2250.00	1	2250.00
178.	253	30'-0" x 75'-0"	2250.00	1	2250.00
179.	254	30'-0" x 75'-0"	2250.00	1	2250.0



ਪੰਜਾਬ ਪ੍ਰਦੂਸ਼ਣ ਕੰਟਰੋਲ ਬੋਰਡ
PUNJAB POLLUTION CONTROL BOARD

No. 5713.....

Dated. 19/3/2026.....

Registered

To

Chief Administrator
Bathinda Development Authority,
Bathinda.

Subject: Constitution of Resident Welfare Association (RWA) in Farid Enclave (Phase-I & II) located at Kotkapura Road, Faridkot - Compliance of order dated 24.02.2026 passed by the Hon'ble National Green Tribunal in OA No. 665 of 2023 titled as Nirmal Singh Versus State of Punjab & Ors.

Reference: Punjab Pollution Control Board, Regional Office Faridkot letter No. 213 dated 03.03.2026.

Please refer to the subject cited above.

2) It is informed that the Hon'ble National Green Tribunal after consideration of the matter in OA No. 665 of 2023 titled as Nirmal Singh Versus State of Punjab & Ors has passed an order dated 24.02.2026 wherein certain directions have been given to the District Magistrate, Superintendent of Police, Bathinda as well as Punjab Pollution Control Board. In para no.15 of the order dated 24.02.2026 following direction has been given:

"The District Magistrate, Bathinda and Punjab Pollution Control Board are directed to issue appropriate directions for constitution of RWAs if not already constituted in respect to all residential and commercial properties. The completion certificate, if any, issued to respondent no. 4 will be subject to compliance by respondent no. 4 with its statutory and contractual obligations."

3) It is brought to your notice that before the passing of orders dated 24.02.2026 by the Hon'ble NGT in OA No. 665 of 2023, the PPCB had extended an opportunity of hearing to all the concerned parties before the undesignated Member Secretary on 12.02.2026 with the issuance of a notice vide letter No.290-292 dated 02.02.2026 in respect of violations being committed by the residential colony Farid Enclave I and II, Faridkot.

4) After hearing all the concerned parties during the hearing held on 12.02.2026, the undersigned in the capacity of Member Secretary, Punjab Pollution Control Board, had taken certain decisions for compliance by the parties. Bathinda Development Authority was assigned certain actions and one of the actions for compliance by the BDA was the "initiation

ਵਾਤਾਵਰਣ ਭਵਨ, ਨਾਭਾ ਰੋਡ, ਪਟਿਆਲਾ-147001
Vatavaran Bhawan, Nabha Road, Patiala -147001

Phone : Chairman. : 0175-2215793, Member Secretary : 0175-2215802 (O)

Website : www.ppcb.gov.in | E-Mail : chairmanppcb@yahoo.in | msppcb@gmail.com

①
Noting No
35418714

Ravideep Singh
Environmental Engineer
Punjab Pollution Control Board
Regional Office, Faridkot



of action for the formation of Resident Welfare Association in consultation with the residents of Farid Enclave Phase - I and II and also the project proponent”.

5) The proceedings of the hearing held on 12.02.2026 were conveyed to all the parties including the Chief Administrator, BDA by the Board vide letter No 433-435 dated 23.02.2026 for compliance. A copy of letter No 435 dated 23.02.2026 is again enclosed herewith for your perusal and necessary action.

6) In compliance to the directions issued by the Hon'ble National Green Tribunal vide orders (para no. 15) dated 24.02.2026 passed in OA No. 665 of 2023 to the Punjab Pollution Control Board and in pursuance of the proceedings of hearing (held on 12.02.2026) as conveyed to your office vide letter no. 433-435 dated 23.02.2026, you are requested to initiate action for the formation of Resident Welfare Association in consultation with the residents of Farid Enclave Phase - I and II and also the project proponent. A copy of order dated 24.02.2026 passed by the Hon'ble National Green Tribunal in Original Application no. 465 of 2023 is enclosed for reference and necessary action please.

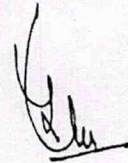
Member Secretary

Endst. no. 5714

Dated 19/3/2026

A copy of the above alongwith annexures is forwarded to the Deputy Commissioner, Faridkot for information please.

Member Secretary

Environmental Engineer
Punjab Pollution Control Board
Regional Office, Faridkot